

Digital signage

D10R

- Powered by the industrial-grade, power-efficient flagship chip RK3568;
- Equipped with the Android 12 OS, and 4+64GB storage configuration;
- Gigabit adaptive Ethernet, dual-band WiFi, BT5.0, optional 4G module;
- USB Type-A/Gigabit Ethernet port/Phoenix terminal interface and more;
- Integrated LED tri-color indicator, optional camera or face recognition;
- Optional barcode scanner/fingerprint module to meet card reading needs;
- Support 7×24H stable operation under wide range of voltage fluctuations;
- IP65-rated front panel, dual-frequency NFC, combining versatility with safety.

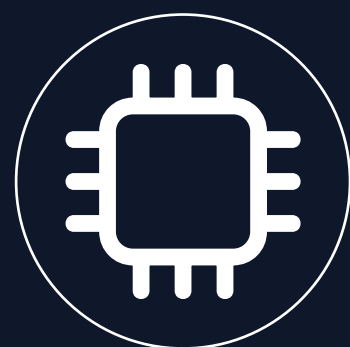

RK3568



Android 12



10.1-inch screen



700cd/m² Brightness



Dual-band
WiFi



Running 24/7 without
affecting reliability

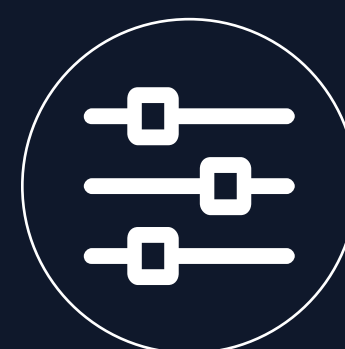

Rich interface
extensions



IP65 Front Panel



Digital signage D10R

Specifications

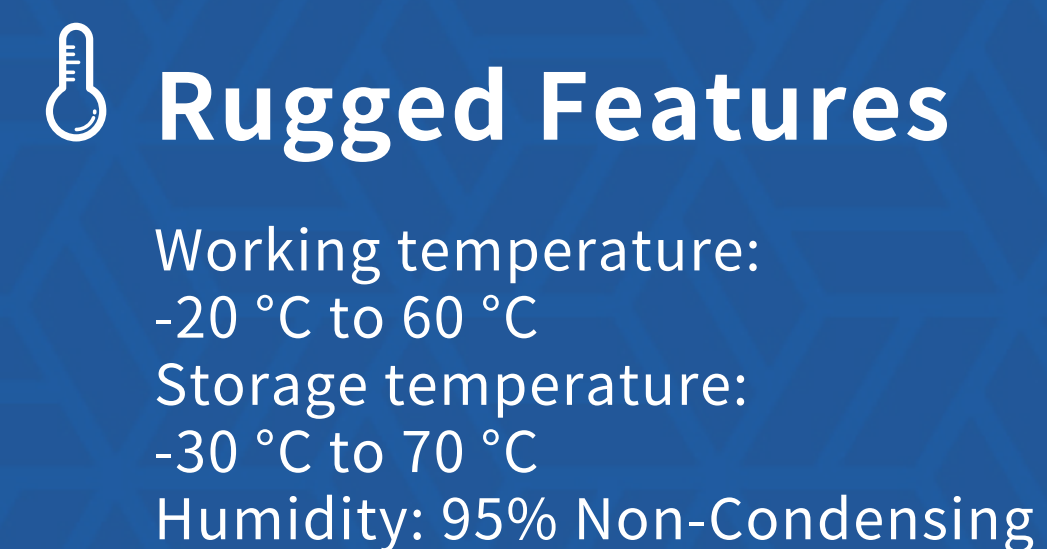
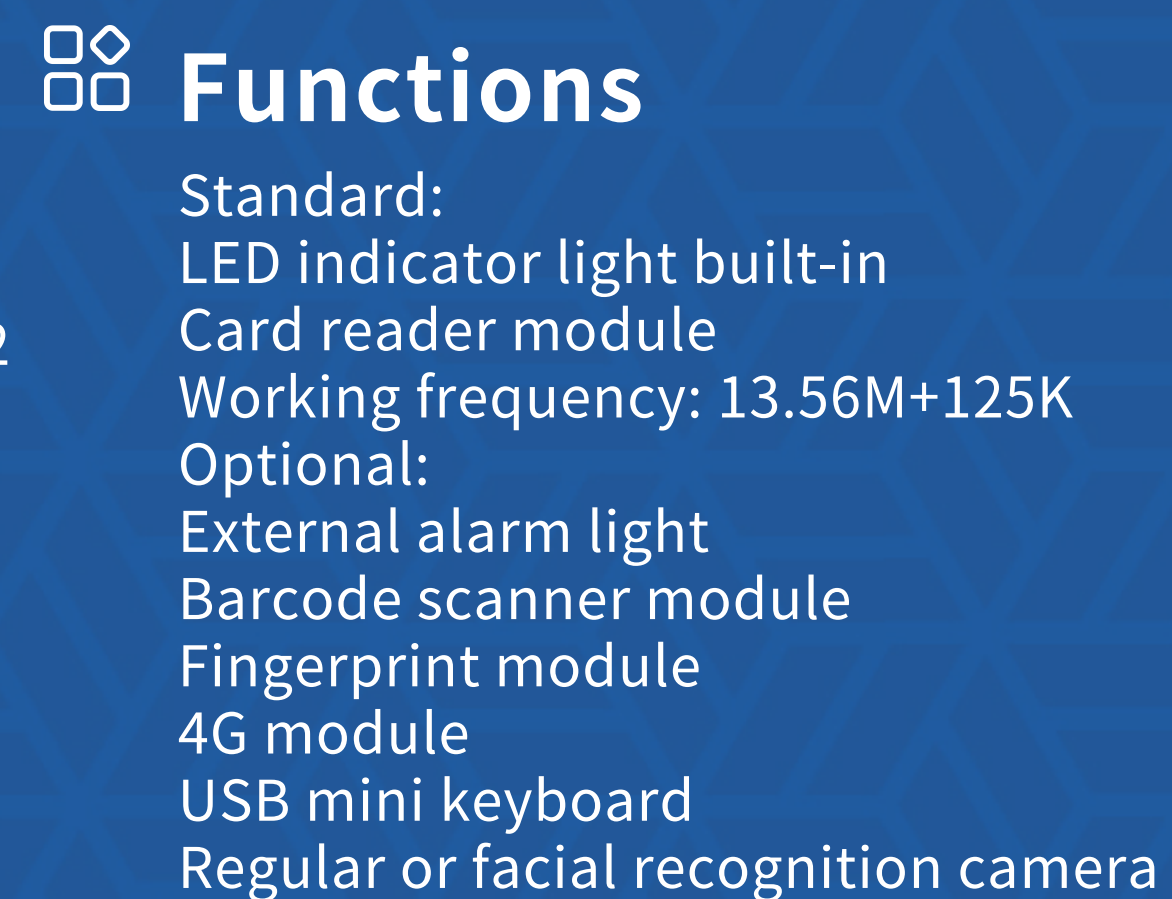
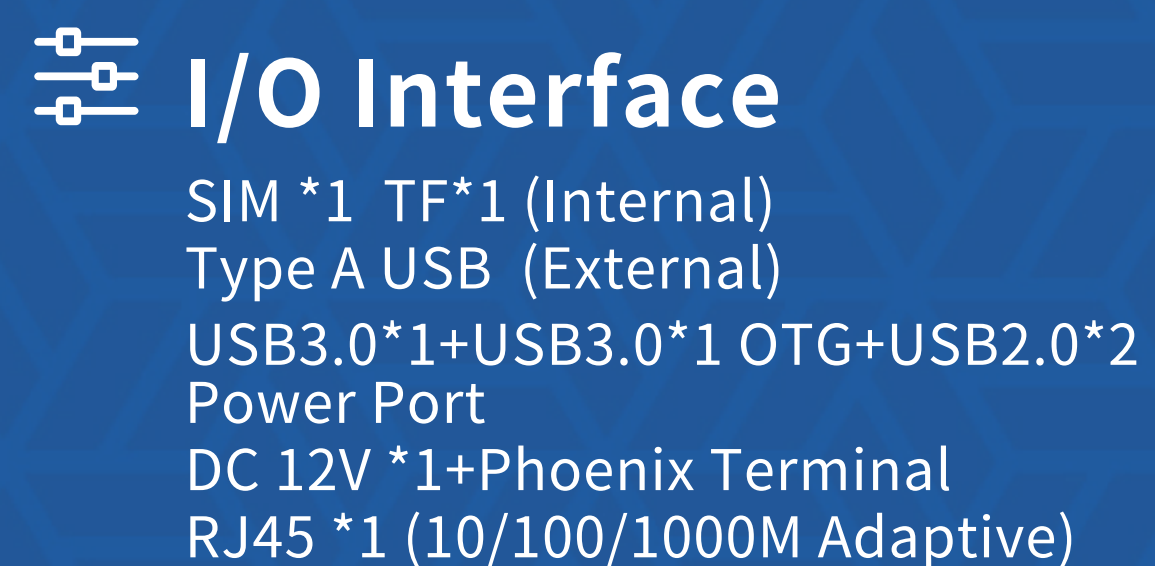
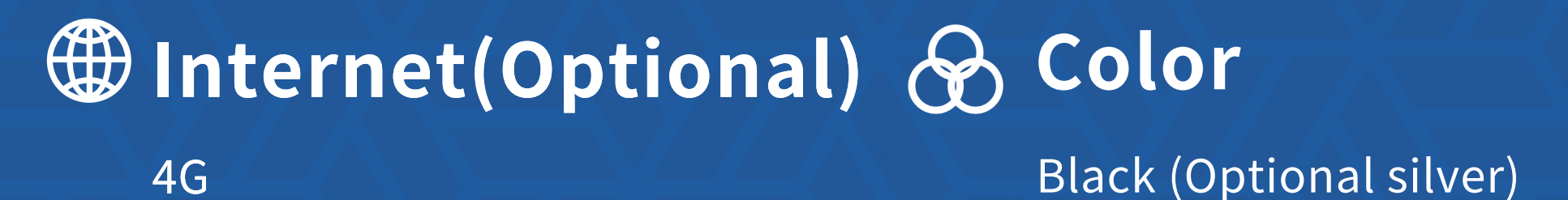
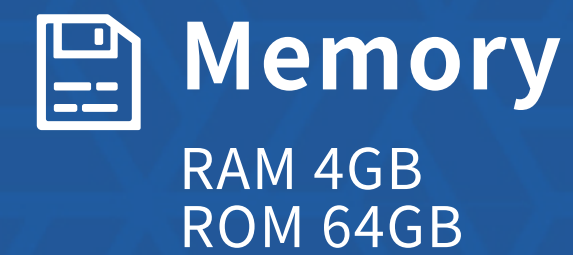

Digital signage D10R

Product Six Views

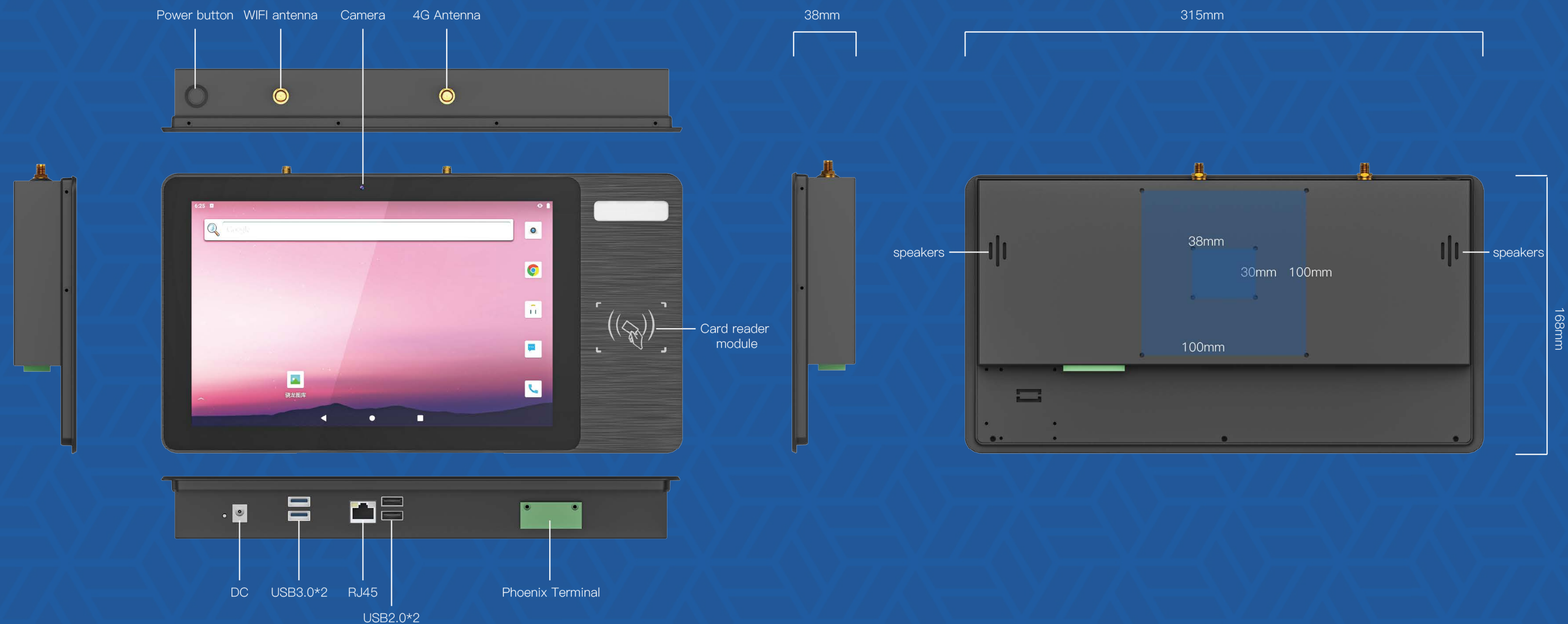

Accessories(Optional)



12V/4A Adapter



Antenna 2.4-2.5/5.15-5.85GHZ 2dBi (SMA)

* The technical specifications of this product are subject to change without prior notice